

SCAS[®] Technical specifications

Typical SCAS Client Schematic

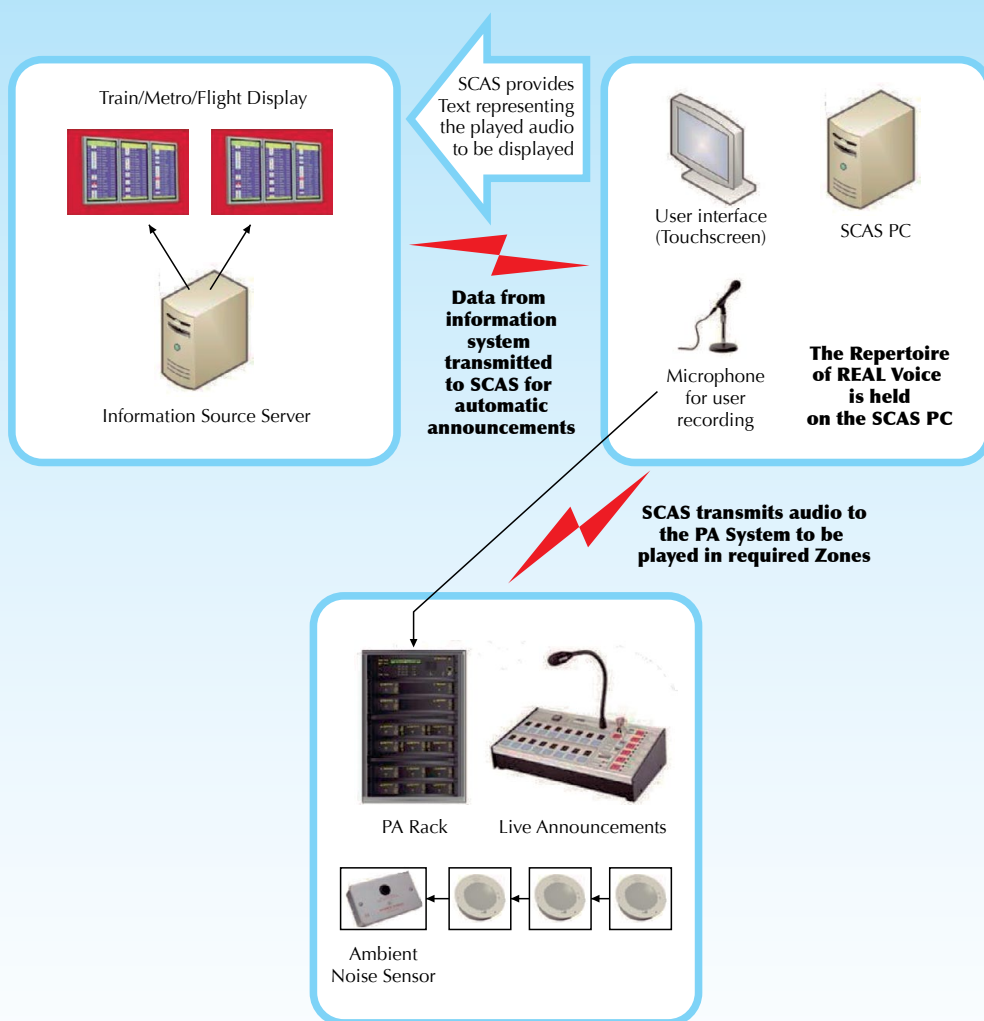



Hardware

Main Unit

- Touch-screen monitor
- X86/PC based computer, processor of 1.6 GHz or better
- 1 Gigabyte main memory or better
- 100 Gigabyte hard drive or better
- Expansion boards for proprietary connections to customer equipment
- RS 485 port (optional expansion board)
- RJ 45 network connection
- USB 2.0 ports

Optional Expansion Boards

- Proprietary connection boards (RS 485 etc)
- Relay Board for connection switching
- Audio amplification module for line level audio connections
- Extra audio boards for additional audio channels if required (7 channels per board)

Connectivity

- TCP/IP via Ethernet/10 Base T (RJ45) connection
- USB 2.0 ports
- Optional RS 485

Power Supply

Standard PC power supply, operates with normal local standard mains electrical supply

Output Device Support

- Audio support for range of PA equipment via proprietary interfaces. RS 485 and TCP/IP and IVR Systems
- Text form of announcements can be displayed on FIDS/VIDS via TCP/IP

Software

Main Unit

- Microsoft Windows XP operating system SP2 or later
- Supporting interface software for proprietary connection hardware
- SCAS® software pre-installed, comprising:
 - SCAS® Client, GUI/MMI/HCI, operated via touch-screen
 - SCAS® Server software
 - SCAS® Repertoire – real voice fragments database

Repertoire management

- User shielded from file management details, repertoire presented to user as hierarchy that they navigate via the GUI
- Audio files are real voice recording fragments with sampling rates up to 44kHz
- Multiple languages supported

Versions of SCAS® software applications and their use

- SCAS® Client - operating via supplied touch-screen for smaller sites operating with single user
- MSCAS® - a Multi Site Client for network operation of multiple systems located at different sites
- SCAS® Client/Server – enabling multiple users sharing server on a single (large) site.
- Remote Diagnostics and Software management via VPN using remote desktop software or similar.